



VASTU-SANSKRUTI

OPP. B. & C. OFFICE
SAMTA COLONY, OSMANABAD
☎ 9403050003, 8788717415

ESTIMATE

Name Of Work: CONSTRUCTION OF SEED PROCESSING MACHINERY UNIT
FOR SUMBHEKAR AGRO PRODUCER COMPANY LTD. SUMBHA, IN GAT. NO. 243,
AT SUMBHA, TQ. & DIST. OSMANABAD.
UNDER STATE OF MAHARASHTRA'S AGRI - BUSINESS & RURAL TRANSFORMATION
PROGRAM (SMART) PROJECT WORLD BANK ASSISTED

ESTIMATE COST Rs.: 50.41 Lakhs

Rajendra Ghodake
Consulting Civil Engineer
Reg.No.CBOOM/R/2021/APL/00237
OMC, Osmanabad
Cell 9403050003/8788717415



Er. Rajendra Ghodake (D.C.E)

VASTU-SANSKRUTI

OPP. B. & C. OFFICE
SAMTA COLONY, OSMANABAD
☎ 9403050003, 8788717415

🏗 ENGINEERS
🏗 CONTRACTORS
🏗 ESTIMATORS
🏗 DESIGNERS
🏗 SURVEYORS

Name Of Work: CONSTRUCTION OF SEED PROCESSING MACHINERY UNIT
FOR SUMBHEKAR AGRO PRODUCER COMPANY LTD. SUMBHA, IN GAT. NO. 243,
AT SUMBHA, TQ. & DIST. OSMANABAD.
UNDER STATE OF MAHARASHTRA'S AGRI - BUSINESS & RURAL TRANSFORMATION PROGRAM (SMART)
PROJECT WORLD BANK ASSISTED

GENERAL REPORT

The work CONSTRUCTION OF SEED PROCESSING MACHINERY UNIT
FOR SUMBHEKAR AGRO PRODUCER COMPANY LTD. SUMBHA, IN GAT. NO. 243,
AT SUMBHA, TQ. & DIST. OSMANABAD. is proposed through मा. बाळासाहेब ठाकरे कृषी
व्यवसाय व ग्रामीण परिवर्तन (SMART) प्रकल्प under World Bank Assisted.

Accordingly detailed estimate is prepared with following provisions

- 1) Excavation for column footings.
- 2) Providing soling & filling in the foundation with sand.
- 2) C.C. M-10 for bed concrete for Flooring.
- 3) R.C.C.Footing, Column, Beams
- 4) TMT steel in R.C..C. work.
- 5) B.B. Masonry in plinth
- 6) External Plastering & Painting.
- 7) cement concrete M20 with tremix treatment for 100 mm thickness for flooring
- 8) Structural Steel & Colour coated sheets for machinery Unit
- 9) Partitions, Furniture Work

And all other necessary provisions are made in the estimate. The rates adopted as per S.S.R. 2022-23 Estimated cost Rs. 50.41 /-.Lakh The early Sanction to the estimate is requested.

Rajendra Ghodake
Consulting Civil Engineer
Reg.No.CBOOM/R/2021/APL/00237
OMC, Osmanabad
Cell 9403050003/8788717415



Er. Rajendra Ghodake (D.C.E)

VASTU-SANSKRUTI

OPP. B. & C. OFFICE

SAMTA COLONY, OSMANABAD

☎ 9403050003, 8788717415

-  ENGINEERS
-  CONTRACTORS
-  ESTIMATORS
-  DESIGNERS
-  SURVEYORS

Name Of Work: CONSTRUCTION OF SEED PROCESSING MACHINERY UNIT
FOR SUMBHEKAR AGRO PRODUCER COMPANY LTD. SUMBHA, IN GAT. NO. 243,
AT SUMBHA, TQ. & DIST. OSMANABAD.
UNDER STATE OF MAHARASHTRA'S AGRI - BUSINESS & RURAL TRANSFORMATION
PROGRAM (SMART) PROJECT WORLD BANK ASSISTED

GENERAL ABSTRACT

A). COST OF WORK PORTION	Rs.	4218599.00
B) Add For Royalty Charges	Rs.	18226.00
C Add For Testing Charges	Rs.	2760.00
D) Add 18% For GST Charges On A	Rs.	759348.00
E) Add 1% For Labour Insurance Charges On A	Rs.	42186.00

Total Cost Rs. 5041119.00

Say Rs. 50.41 Lakhs

Rajendra Ghodake
Consulting Civil Engineer
Reg.No.CBOOM/R/2021/APL/00237
OMC, Osmanabad
Cell 9403050003/8788717415







Er. Rajendra Ghodake (D.C.E)

VASTU-SANSKRUTI

OPP. B. & C. OFFICE

SAMTA COLONY, OSMANABAD

9403050003, 8788717415

-  ENGINEERS
-  CONTRACTORS
-  ESTIMATORS
-  DESIGNERS
-  SURVEYORS

**Name Of Work: CONSTRUCTION OF SEED PROCESSING MACHINERY UNIT
FOR SUMBHEKAR AGRO PRODUCER COMPANY LTD. SUMBHA, IN GAT. NO. 243,
AT SUMBHA, TQ. & DIST. OSMANABAD.
UNDER STATE OF MAHARASHTRA'S AGRI - BUSINESS & RURAL TRANSFORMATION
PROGRAM (SMART) PROJECT WORLD BANK ASSISTED**

ABSTRACT

QTY	DESCRIPTION	RATE	UNIT	AMOUNT
49.94	ITEM No.1: Excavation for foundation in earth, soil of all types, sand, gravel and soft murum, including removing the excavated material up to a distance of 50 m. beyond the building area and stacking and spreading as directed, dewatering, preparing the bed for the foundation and necessary back filling, ramming, watering including shoring and strutting etc. complete. (Lift upto 1.5 m.) By Mechanical Means Addnl. Spec.: Bd.A.1 Page One Number 259 SSR 2022-23 Item No. 21.02 Page No. 153	207.00	Cu.M.	10338.00
27.22	ITEM No.2: Excavation for foundation in hard murum including removing the excavated material upto distance of 50 metres beyond the building area and stacking and spreading as directed, dewatering, preparing the bed for the foundation and necessary back filling, ramming, watering including shoring and strutting etc. complete. (Lift upto 1.50 m) By Mechanical Means Addnl. Spec.: Bd.A.2 Page One Number 259 SSR 2022-23 Item No. 21.06 Page No. 153	227.00	Cu.M.	6179.00
10.32	ITEM No.3: Filling in plinth and floors with approved excavated material in 15cm. to 20cm. Layers including watering and compacting etc. complete. Addnl. Spec.: Bd.A.10 Page One Number 262 SSR 2022-23 Item No. 21.36 Page No. 157	120.00	Cu.M.	1238.00

QTY	DESCRIPTION	RATE	UNIT	AMOUNT
10.32	<p>ITEM No.4: Filling in plinth and floors with contractors material/brought from outside and approved by Engineer incharge in layers of 15 cm to 20 cm including watering and compaction etc. complete.</p> <p>Addnl. Spec.: Bd.A.11 Page One Number 263 SSR 2022-23 Item No. 21.37 Page No. 157</p>	818.98	Cu.M.	8452.00
73.99	<p>ITEM No.5: Providing soling using 80 mm size trap metal in 15 cm. layer including filling voids with Crushed sand/grit, ramming, watering etc. complete.</p> <p>Addnl. Spec.: As Directed by Engineer In Charge SSR 2022-23 Item No. 21.40 Page No. 157</p>	1836.54	Cu.M.	135886.00
9.09	<p>ITEM No.6: Providing and filling in the foundation with sand of approved quality including watering, compacting etc. complete. (To be executed with prior approval of Superintending Engineer)</p> <p>Addnl. Spec.: Bd.A.13 Page One Number 264 SSR 2022-23 Item No. 21.39 Page No. 157</p>	2505.15	Cu.M.	22772.00
23.60	<p>ITEM No.7: Providing and laying Cast in situ/Ready Mix cement concrete in M-10 of trap/ granite/ quartzite/ gneiss metal for foundation and bedding including bailing out water, Steel centering, formwork, laying/pumping, compacting, roughening them if special finish is to be provided, finishing if required and curing complete, with fully automatic micro processor based PLC with SCADA enabled reversible Drum Type mixer/concrete Batch mix plant (Pan mixer) etc. complete. With fine aggregate (Crushed sand VSI Grade)</p> <p>Addnl. Spec.: Bd. E. 1 Page One Number 287 SSR 2022-23 Item No. 24.01 Page No. 175</p>	6247.86	Cu.M.	147449.00

QTY	DESCRIPTION	RATE	UNIT	AMOUNT
14.18	<p>ITEM No.8: Providing and laying in situ /Ready Mix cement concrete M-20 of trap / granite/quartzite/ gneiss metal for R.C.C. work in foundations like raft, strip foundations, grillage and footings of R.C.C. columns and steel stanchions etc. including bailing out water, Steel centering formwork, laying/pumping cover blocks, compaction and curing roughening the surface if special finish is to be provided (Excluding reinforcement and structural steel) etc. complete, with fully automatic micro processor based PLC with SCADA enabled reversible Drum Type mixer/ concrete Batch mix plant (Pan mixer) etc. complete. With fine aggregate (Crushed sand VSI Grade) Addnl. Spec.: Bd.F.3 Page One Number 298 and B.7, Page One Number38 SSR 2022-23 Item No. 25.11 Page No. 178</p>	7549.34	Cu.M.	107050.00
	<p>ITEM No.9: Providing and laying Cast in situ/Ready Mix cement concrete M-20 of trap / granite /quartzite/ gneiss metal for R.C.C. columns as per detailed designs and drawing or as directed including steel centering, formwork, cover blocks, laying/pumping, compaction finishing the formed surfaces with cement mortar 1:3 of sufficient minimum thickness to give a smooth and even surface or roughening if special finish is to be provided and curing etc. complete.(Excluding reinforcement and structural steel).with fully automatic micro processor based PLC with SCADA enabled reversible Drum Type mixer/ concrete Batch mix plant (Pan mixer) etc. complete. With fine aggregate (Crushed sand VSI Grade) Addnl. Spec.: Bd.F.5 Page One Number 300 and B.7, Page.One Number 38 SSR 2022-23 Item No. 25.31 Page No. 179</p>			
5.95	Lift Upto 3.80 Mtr. From Plinth	14228.34	Cu.M.	84659.00

QTY	DESCRIPTION	RATE	UNIT	AMOUNT
	<p>ITEM No.10: Providing and laying Cast in situ/Ready Mix cement concrete M-20 of trap / granite/quartzite/ gneiss metal for R.C.C. beams and lintels as per detailed designs and drawings or as directed including steel centering, formwork, cover blocks, laying/pumping, compaction and roughening the surface if special finish is to be provided and curing etc. complete. (Excluding reinforcement and structural steel). with fully automatic micro processor based PLC with SCADA enabled reversible Drum Type mixer/ concrete Batch mix plant (Pan mixer) etc. complete. With fine aggregate (Crushed sand VSI Grade)</p> <p>Addnl. Spec.: Bd.F.6 Page One Number 300 and B.7, Page One Number 38</p> <p>SSR 2022-23 Item No. 25.50 Page No. 181</p>			
5.87	Lift Upto 3.80 Mtr. From Plinth	12714.34	Cu.M.	74633.00
	<p>ITEM No.11: Providing and fixing in position TMT - FE - 500 bar reinforcement of various diameters for R.C.C. pile caps, footings, foundations, slabs, beams columns, canopies, staircase, newels, chajjas, lintels pardis, copings, fins, arches etc. as per detailed designs, drawings and schedules. including cutting, bending, hooking the bars, binding with wires or tack welding and supporting as required complete.</p> <p>Addnl. Spec.: Bd.F.17, Page One Number 306</p> <p>SSR 2022-23 Item No. 26.33 Page No. 188</p>			
2.13	Lift Upto 3.80 Mtr. From Plinth	89972.45	M.T	191407.00
19.44	<p>ITEM No.12: Providing second class Burnt Brick masonry with conventional/ I.S. type bricks in cement mortar 1:6 in foundations and plinth of inner walls/ in plinth external walls including bailing out water manually , striking joints on unexposed faces, raking out joints on exposed faces and watering etc. Complete.</p> <p>Addnl. Spec.: Bd.G. 1 Page One Number 313</p> <p>SSR 2022-23 Item No. 27.01 Page No. 197</p>	8321.11	Cu.M.	161762.00

QTY	DESCRIPTION	RATE	UNIT	AMOUNT
	<p>ITEM No.13: Providing sand faced plaster externally in cement mortar using approved screened sand, in all positions including base coat of 15 mm thick in cement mortar 1:4 using waterproofing compound at 1Kilogramper cement bag curing the same for not less than 2 days and keeping the surface of the base coat rough to receive the sand faced treatment 6 to 8 mm thick in cement mortar 1:4 finishing the surface by taking out grains and curing for fourteen days scaffolding etc.complete.</p> <p>Addnl. Spec.: Bd.L.7 Page One Number 369 SSR 2022-23 Item No. 32.11 Page No. 209</p>			
88.88	Lift Upto 3.80 Mtr. From Plinth	655.29	Sq.M	58242.00
287.20	<p>ITEM No.14: Providing and laying in situ cement concrete M20 with tremix treatment for 100 mm thickness for flooring with groove cutting of 4mm wide and 20mm deep with necessary refilling with bitumen etc. complete.</p> <p>Addnl. Spec.: As Directed by Engineer In Charge SSR 2022-23 Item No. 33.30 Page No. 216</p>	851.40	Sq.M	244522.00
	<p>ITEM No.15: Providing and fixing mild steel grill work for windows, ventilators etc. 20 Kilogram/ One Square Metre as per drawing including fixtures, necessary welding and painting with one coats of anticorrosive paint and two coats of oil painting complete.</p> <p>Addnl. Spec.: Bd.U.1 Page One Number 537 SSR 2022-23 Item No. 40.01 Page No. 264</p>			
23.40	Lift Upto 3.80 Mtr. From Plinth	2097.00	Sq.M	49070.00

QTY	DESCRIPTION	RATE	UNIT	AMOUNT
23.40	<p>ITEM No.16: Providing and fixing in position (as per 1868 / 1982) Aluminium sliding window of three tracks with rectangular pipe 95 x 38.10 x 0.90 mm at weight 0.637 Kilogram/One Running Metre. with window frame bottom track section 92 x 31.75 x 1.30 mm at weight 1.070 Kilogram/One Running Metre.. Top and side track section 92 x 31.75 x 1.30 mm at weight 0.933 Kilogram/Running metre. The shutter should be of bearing bottom 40 x 18 x 1.25 mm at weight 0.417 Kilogram/One Running Metre. Inter locking section 40 x 18 x 1.10 mm at weight 0.469 Kilogram/Running metre. and handle and top section 40 x 18 x 1.25 mm at weight 0.417 Kilogram/Running metre. As per detailed drawings and as directed by Engineerincharge with all necessary Aluminium sections fixtures and fastenings such as roller bearing in nylon casting and self locking catch fitted in vertical section of shutter including 5 mm thick plain glass and aluminium mosquito net shutter with stainless steel jail with all required screws and nuts etc, complete.</p> <p>With powder coating without box Addnl. Spec.: As Directed by Engineer In Charge SSR 2022-23 Item No. 39.44 Page No. 254</p>	4968.00	Sq.M	116251.00
	<p>ITEM No.17: Providing and fixing rolling shutter fabricated from steel laths of minimum thickness 0.9 mm with lock plate of 3.15 mm thickness reinforced with 35 x 35 x 5 mm angle section fitted with sliding bolts and handles for both sides, deep M.S. channel section of depth and thickness not less than 65 mm and 3.15 mm respectively with hold fast arrangements, M.S. Bracket plate 300 x 300 x 3.15 mm minimum size and shape with square bar, suspension shaft of minimum 32 mm diameter, hood cover of M.S. sheet not less than 0.9 mm thickness and of any size at top and safety devices including mechanical gear operation arrangement consisting of worm gear wheels and worms of high grade cast iron or mild steel and one coat of red lead primer etc. complete. (I.S. 62481979)</p> <p>(With mechanical gear) Addnl. Spec.: BD-T-55 Page One Number 510 SSR 2022-23 Item No. 39.25 Page No. 249</p>			
15.39	Lift Upto 3.80 Mtr. From Plinth	5308.00	Sq.M	81 690.00
17.42	Lift Above 3.80 To 7.60 Mtr.	5361.08	Sq.M	93390.00

QTY	DESCRIPTION	RATE	UNIT	AMOUNT
242.69	<p>ITEM No.18: Providing preconstructional antitermite treatment as per I.S. 6313 (Part-II) by treating the top surface of plinth filling at the rate of 5 litres of emulsion concentrate at 1.0 percent of clorophyrifos per One Square Metre of surface area covering ten years guarantee on bond paper.</p> <p>Addnl. Spec.: As Directed by Engineer In Charge SSR 2022-23 Item No. 21.24 Page No. 156</p>	108.00	Sq.M	26211.00
	<p>ITEM No.19: Providing and fabricating structural steel work in rolled sections like joists, channels, angles, tees etc. as per detailed design and drawings or as directed including cutting, fabricating, hoisting, erecting, fixing in position making riveted / bolted/welded connections without connecting plates, braces etc. and including one coat of anticorrosive paint and over it two coats of oil painting of approved quality and shade etc. complete.</p> <p>Addnl. Spec.: Bd.C.2 Page One Number 275 SSR 2022-23 Item No. 23.01 Page No. 173</p>			
1.68	Lift Upto 3.80 Mtr. From Plinth	102113.45	M.T.	171551.00
1.55	Lift Above 3.80 To 7.60 Mtr.	103131.89	M.T.	159854.00
5.69	Lift Above 7.60 To 11.40 Mtr.	104150.33	M.T.	592615.00
	<p>ITEM No.20: Providing and fixing colour coated Zinalume (R) AZ150 (min 150 gms/sq.mt. total on each side) profiled sheets for roofing. The feed material is manufactured out of nominal 0.45 mm Base Metal Thickness (BMT) (0.5 mm TCT), Hi-strength steel with min.550 MPa yield strength, metallic hot dip coated with Aluminium-Zinc alloy (55% aluminium 43.4% zinc 1.6% silicon) with COLORBOND (R) steel quality super durable polyester paint coat (with inorganic pigment). The paint shall have a total coating thickness of nominal 35 um, comprising of nominal 25 um exterior coat on top surface and nominal 10 um reverse coat on back surface. Profile sheet shall have nom. 950- 1050 mm effective cover width and nominal 25-30 mm deep ribs with subtle square fluting in the five pan at nominal 180-250 mm center- to-center. The end rib shall be designed for anti-capillary groove. and return leg. The feed material should have coil manufacturers product details marked a regular interval. Including fasteners with min. fastened with min. 25 um Zinc-Tin alloy coated, Hex head, self-drilling screw etc. complete. (weight of profile 4.52 Kilogram/ One Square Metre)</p> <p>Addnl. Spec.: As Directed by Engineer In Charge SSR 2022-23 Item No. 38.34 Page No. 236</p>			
203.88	Lift Upto 3.80 Mtr. From Plinth	1173.00	Sq.M.	239151.00
227.28	Lift Above 3.80 To 7.60 Mtr.	1184.73	Sq.M.	269265.00
375.36	Lift Above 7.60 To 11.40 Mtr.	1196.46	Sq.M.	449103.00

QTY	DESCRIPTION	RATE	UNIT	AMOUNT
	<p>ITEM No.21: Providing and fixing plain zinc sheeting of 0.80 mm thick (22 B.W.G.) over the ridge hip or valley to galvanized iron sheet roofing including all fastening and bolt galvanised iron screws and bolts, lead and bitumen washers etc. complete.(Weight of 6.8 Kilogram/sq.m.).</p> <p>Addnl. Spec.: Bd.R.5, Page One Number 453 SSR 2022-23 Item No. 38.05 Page No. 233</p>			
4.56	Lift Upto 3.80 Mtr. From Plinth	1139.00	Sq.M.	5194.00
4.56	Lift Above 3.80 To 7.60 Mtr.	1150.39	Sq.M.	5246.00
17.32	Lift Above 7.60 To 11.40 Mtr.	1161.78	Sq.M.	20122.00
87.39	<p>ITEM No.22: Providng and fixing in position anodised extruded aluminum partitions, partly glazed and partly laminated having frame made out of extruded tubular section of size 40 mm x 60 mm with 12 mm thick three layered flat pressed teak wood particle board bonded with BWP type exterior grade phenol formaldehyde synthetic resin conforming to IS 128231990, laminated on both sides,Novateakor equivalent and 5 mm thick selected quality plain/ float glass panels fixed with aluminum glass clips 12 mm x 12 mm and rubber cushioning beading to glass partitions as per approved drawing etc. compete</p> <p>Addnl. Spec.: As Directed by Engineer In Charge SSR 2022-23 Item No. 39.72 Page No. 260</p>	4046.00	Sq.M.	353580.00
7.56	<p>ITEM No.23: Providing and fixing in position, Single shuttered aluminium extruded powder coated openable door of overall size 0.90 m x 2.40 m with aluminium door frame of powder coated section 101.60 x 44.75mm , 3.18 mm thick and shutter comprising of powder coated section having bottom and lock rail of size 150 mm x 44.5 mm x 3.00 mm thick top rails 47.62 x 44.45 mm x 3.00 mm thick , vertical style 47.62 x 44.45 mm, 3.00 mm thick and for shutter plain glass panes 5 mm thick for top panels and 12mm thick both side laminated phenol bonded particle board panels for bottom panels etc. , I.S.I. mark , with bijagiri having heavy duty concealed lock, necessary beading, glazing clips, PVC gaskets, 250mm length tower bolts, 150mm diam. pad handle, etc. as per detailed design and drawing or as directed by engineer in charge including all materials , labours, and equipment etc. complete</p> <p>Addnl. Spec.: As Directed by Engineer In Charge SSR 2022-23 Item No. 39.65 Page No. 259</p>	9387.00	Sq.M.	70966.00

QTY	DESCRIPTION	RATE	UNIT	AMOUNT
90.14	ITEM No.24: Providing and fixing 1.5 mm thick polyvenyl vinyl chloride flooring including leveling the base with white cement including pasting with appropriate material cleaning the surface etc. complete Addnl. Spec.: Bd.M.35C / Page One Number 393 SSR 2022-23 Item No. 33.39 Page No. 217	641.00	Sq.M.	57780.00
2.00	ITEM No.25: Executive's Table @ 1800Lx900Dx750HT Providing & Fixing of Table @ 1800Lx900Dx750HT - TOP & GABLE END to be made of Membrane finish with soft water fall edges & curved panel & Decorated Anodized section MODESTY PANEL to be made of 18 mm thick Prelaminated particle board with PVC edge band as per drawing Addnl. Spec.: As Directed by Engineer In Charge SSR 2022-23 Item No. 51.21 Page No. 355	17231.00	No.	34462.00
1.00	ITEM No.26: Providing & Arrangemnt of High Back Chair - TILT MECHANISM WITH MULTILOCKING, HIGH DENSITY CUSHION ON SEAT COMPOSITE LEATHER WITH METALLIC SILVER FINISH BASE AND ARMS WITH P.U.CASTORS GASLIFT FOR HEIGHT ADJUSTMENT. Addnl. Spec.: As Directed by Engineer In Charge SSR 2022-23 Item No. 51.41 Page No. 359	15474.00	No.	15474.00
2.00	ITEM No.27: Providing & Arrangemnt of Mld Back, Normal Syncro Mechanism , Fixed Armrest , Gaslift for Seat height adjustment, Standard 5-prong/Nylon Base with Leather Upholstery Addnl. Spec.: As Directed by Engineer In Charge SSR 2022-23 Item No. 51.42 Page No. 359	9563.00	No.	19126.00
2.00	ITEM No.28: Public Seating Chair. - 3 Seater Providing and Fixing 3 seater Public seating chair made of complete metal with Legs in Crome finish and seates in silver powder coating finish. Addnl. Spec.: As Directed by Engineer In Charge SSR 2022-23 Item No. 51.44 Page No. 359	18056.00	No.	36112.00
2.00	ITEM No.29: Full Height Steel Storage @ 750Lx450Dx2100HT Providing and fixing Openable Steel Storage of 750 x 450 x 2100Ht, with 4 adjustable shelves, Complete body & shutter made in 0.8 mm thick & Top in 2 mm thick CRCA, 4 Shutter to be mounted with the help of cup hinges, and 4 adjustable levelers, enitre storage in powder coated finish with 60 to 80 microns as as per drawing. Addnl. Spec.: As Directed by Engineer In Charge SSR 2022-23 Item No. 51.37 Page No. 359	18925.00	No.	37850.00

QTY	DESCRIPTION	RATE	UNIT	AMOUNT
1.00	ITEM No.30: Multiple Compartment Lockers @ 1140Lx 457D x 1830 mm. Ht. Providing and fixing Multiple Compartment Lockers @ 1140Lx 457D x 1830 mm. Ht. with 12 Compartments , Complete body & shutter made of CRCA Sheet with powder coated finish as per approved color. Addnl. Spec.: As Directed by Engineer In Charge SSR 2022-23 Item No. 51.38 Page No. 359	43427.00	No.	43427.00
	ITEM No.31: Providing and applying two coats of water proof cement paint of approved manufacture and of approved colour to the plastered surfaces including scaffolding if necessary, cleaning and preparing the surface, watering for two days etc. complete. Addnl. Spec.: Bd.0.8 Page One Number 406 SSR 2022-23 Item No. 35.13 Page No. 224			
88.88	Lift Upto 3.80 Mtr. From Plinth	79.00	Sq.M.	7022.00
	ITEM No.32: Providing and applying two coats of synthetic enamel paint of approved colour to new /old structural steel work and wood work in buildings, including scaffolding if necessary, cleaning and preparing the surface (excluding primer coat) etc. complete. Addnl. Spec.: Bd.O.5 Page One Number 405 SSR 2022-23 Item No. 35.07 Page No. 223			
46.17	Lift Upto 3.80 Mtr. From Plinth	96.00	Sq.M.	4432.00
52.25	Lift Above 3.80 To 7.60 Mtr.	96.96	Sq.M.	5066.00
	TOTAL WORK PORTION =			4218599.00
	ITEM No.33: Royalty charges for supply of Sand, Rubble, Murum, Soil, 60mm./40mm. metal (Hand broken) as per The Government of Maharashtra, Revenue and Forest Departments Gazette No.146 Dt. 04 June 2021 States that the Royalty charges of Rs. 600/- Per Brass (i.e. Rs.211.95 /cum.) are to be considered. The surcharge levied on Royalty shall also be payable to the contractor in following manner . Royalty charges on all minor minerals do not form part of Rate Abstract and shall be reimbursed separately on production of proof to that effect. The Superintending Engineer, PWD may modify and circulate Royalty charges in case of any modifications are made by Govt. of Maharashtra. Royalty charges against estimated quantity shall be included in Recapitulation sheet. a) For sand = Royalty + surcharge (2%) + Distt. Mineral Foundation Cess (10%) = 211.95+4.23+21.19 = 237.37 Per Cum b) For All Other Minerals = Royalty + surcharge (2%) = 211.95+4.23 = 216.18 per cum			
0.00	Sand	237.37	Cu.M.	0.00
84.31	Other Material	216.18	Cu.M.	18226.00
	TOTAL ROYALTY CHARGES =			18226.00

QTY	DESCRIPTION	RATE	UNIT	AMOUNT
	<p>ITEM No.34: Laboratory testing charges for various materials, on the basis of testing frequency and charges fixed by Vigilance & Quality Control Circle, for the current year.</p> <p>For Specific tests like span load tests, plate/ pile load test etc. which are not included in the rate analysis of item, the rates for these tests will be prepared on the basis of rates approved by M.E.R.I./ any competent Institute of Govt. of Maharashtra or Govt. of India.</p>			
4.00	CONCRETE Compressive Strength OF C.C. Cube(Set of 3 cubes).	690.00	1 Test	2760.00
TOTAL TESTING CHARGES =				2760.00

Rajendra Ghodake
 Consulting Civil Engineer
 Reg.No.CBOOM/R/2021/APL/00237
 OMC, Osmanabad
 Cell 9403050003/8788717415



VASTU-SANSKRUTI

OPP. B. & C. OFFICE

SAMTA COLONY, OSMANABAD

☎ 9403050003, 8788717415

- 🏗 ENGINEERS
- 🏗 CONTRACTORS
- 🏗 ESTIMATORS
- 🏗 DESIGNERS
- 🏗 SURVEYORS

Name Of Work: CONSTRUCTION OF SEED PROCESSING MACHINERY UNIT
FOR SUMBHEKAR AGRO PRODUCER COMPANY LTD. SUMBHA, IN GAT. NO. 243,
AT SUMBHA, TQ. & DIST. OSMANABAD.
UNDER STATE OF MAHARASHTRA'S AGRI - BUSINESS & RURAL TRANSFORMATION PROGRAM
(SMART) PROJECT WORLD BANK ASSISTED

MEASUREMENT

DESCRIPTION	NOS	L	B	D/H	QTY	Unit
<p>ITEM No.1: Excavation for foundation in earth, soil of all types, sand, gravel and soft murum, including removing the excavated material up to a distance of 50 m. beyond the building area and stacking and spreading as directed, dewatering, preparing the bed for the foundation and necessary back filling, ramming, watering including shoring and strutting etc. complete. (Lift upto 1.5 m.) By Mechanical Means Addnl. Spec.: Bd.A.1 Page One Number 259 SSR 2022-23 Item No. 21.02 Page No. 153</p>						
For Seed Processing Machinery Unit Column Footings F1, F2, F3, F4, F5, F6, F7, F8, F9, F10, F11, F12, F13, F14	14	1.80	1.80	0.90	40.82	
For Seed Processing Machinery Unit G. L. Beams C1-C2, C2-C3, C3-C4, C11-C12, C12-C13, C13-C14	6	2.70	0.30	0.30	1.46	
For Seed Processing Machinery Unit G. L. Beams C1-C5, C5-C7, C7-C9, C9-C11 C4-C6, C6-C8, C8-C10, C10-C14	8	2.70	0.30	0.30	1.94	
For Seed Processing Machinery Unit Ramp Walls	1x2	6.00	0.53	0.90	5.72	
				Total	49.94	Cu.M.
<p>ITEM No.2: Excavation for foundation in hard murum including removing the excavated material upto distance of 50 metres beyond the building area and stacking and spreading as directed, dewatering, preparing the bed for the foundation and necessary back filling, ramming, watering including shoring and strutting etc. complete. (Lift upto 1.50 m) By Mechanical Means Addnl. Spec.: Bd.A.2 Page One Number 259 SSR 2022-23 Item No. 21.06 Page No. 153</p>						
For Seed Processing Machinery Unit Column Footings F1, F2, F3, F4, F5, F6, F7, F8, F9, F10, F11, F12, F13, F14	14	1.80	1.80	0.60	27.22	
				Total	27.22	Cu.M.

ITEM No.8: Providing and laying in situ /Ready Mix cement concrete M-20 of trap / granite/quartzite/ gneiss metal for R.C.C. work in foundations like raft, strip foundations, grillage and footings of R.C.C. columns and steel stanchions etc. including bailing out water, Steel centering formwork, laying/pumping cover blocks, compaction and curing roughening the surface if special finish is to be provided (Excluding reinforcement and structural steel) etc. complete, with fully automatic micro processor based PLC with SCADA enabled reversible Drum Type mixer/ concrete Batch mix plant (Pan mixer) etc. complete. With fine aggregate (Crushed sand VSI Grade)
Addnl. Spec.: Bd.F.3 Page One Number 298 and B.7, Page One Number38
SSR 2022-23 Item No. 25.11 Page No. 178

For Column Footings

For Seed Processing Machinery Unit
Column Footings F1, F2, F3, F4, F5, F6, F7, F8, F9, F10, F11, F12, F13, F14

14

1.50

1.50

0.45

14.18

Total

14.18

Cu.M.

ITEM No.9: Providing and laying Cast in situ/Ready Mix cement concrete M-20 of trap / granite /quartzite/ gneiss metal for R.C.C. columns as per detailed designs and drawing or as directed including steel centering, formwork, cover blocks, laying/pumping, compaction finishing the formed surfaces with cement mortar 1:3 of sufficient minimum thickness to give a smooth and even surface or roughening if special finish is to be provided and curing etc. complete.(Excluding reinforcement and structural steel).with fully automatic micro processor based PLC with SCADA enabled reversible Drum Type mixer/ concrete Batch mix plant (Pan mixer) etc. complete. With fine aggregate (Crushed sand VSI Grade)
Addnl. Spec.: Bd.F.5 Page One Number 300 and B.7, Page.One Number 38
SSR 2022-23 Item No. 25.31 Page No. 179

For Columns Upto G. L.

For Seed Processing Machinery Unit
Columns C1, C2, C3, C4, C5, C6, C7, C8, C9, C10, C11, C12, C13, C14

14

0.45

0.45

0.90

2.55

For Columns Above G. L.

For Seed Processing Machinery Unit
Columns C1, C2, C3, C4, C5, C6, C7, C8, C9, C10, C11, C12, C13, C14

14

0.45

0.45

1.20

3.40

Total

5.95

Cu.M.

ITEM No.10: Providing and laying Cast in situ/Ready Mix cement concrete M-20 of trap / granite/quartzite/ gneiss metal for R.C.C. beams and lintels as per detailed designs and drawings or as directed including steel centering, formwork, cover blocks, laying/pumping, compaction and roughening the surface if special finish is to be provided and curing etc. complete. (Excluding reinforcement and structural steel). with fully automatic micro processor based PLC with SCADA enabled reversible Drum Type mixer/ concrete Batch mix plant (Pan mixer) etc. complete. With fine aggregate (Crushed sand VSI Grade)
Addnl. Spec.: Bd.F.6 Page One Number 300 and B.7, Page One Number38
SSR 2022-23 Item No. 25.50 Page No. 181

For G. L. Beams

For Seed Processing Machinery Unit
G. L. Beams
C1-C2, C2-C3, C3-C4,
C11-C12, C12-C13, C13-C14

6

4.05

0.23

0.45

2.52

ITEM No.13: Providing sand faced plaster externally in cement mortar using approved screened sand, in all positions including base coat of 15 mm thick in cement mortar 1:4 using waterproofing compound at 1Kilogramper cement bag curing the same for not less than 2 days and keeping the surface of the base coat rough to receive the sand faced treatment 6 to 8 mm thick in cement mortar 1:4 finishing the surface by taking out grains and curing for fourteen days scaffolding etc.complete.
Addnl. Spec.: Bd.L.7 Page One Number 369
SSR 2022-23 Item No. 32.11 Page No. 209

Seed Processing Machinery Unit						
F/S & B/S	2	13.95		1.35	37.67	
L/S & R/S	2	18.45		1.35	49.82	
For Seed Processing Machinery Unit Ramp Walls	1x2x1/2	6.00		1.35	8.10	
Deductions						
Ramp	1	4.97		1.35	-6.71	
				Total	88.88	Sq.M

ITEM No.14: Providing and laying in situ cement concrete M20 with tremix treatment for 100 mm thickness for flooring with groove cutting of 4mm wide and 20mm deep with necessary refilling with bitumen etc. complete.
Addnl. Spec.: As Directed by Engineer In Charge
SSR 2022-23 Item No. 33.30 Page No. 216

Seed Processing Machinery Unit	1	13.95	18.45		257.38	
For Ramp	1	6.00	4.97		29.82	
				Total	287.20	Sq.M

ITEM No.15: Providing and fixing mild steel grill work for windows, ventilators etc. 20 Kilogram/ One Square Metre as per drawing including fixtures, necessary welding and painting with one coats of anticorrosive paint and two coats of oil painting complete.
Addnl. Spec.: Bd.U.1 Page One Number 537
SSR 2022-23 Item No. 40.01 Page No. 264

W						
Seed Processing Machinery Unit W	13	1.50		1.20	23.40	
				Total	23.40	Sq.M

ITEM No.16: Providing and fixing in position (as per 1868 / 1982) Aluminium sliding window of three tracks with rectangular pipe 95 x 38.10 x 0.90 mm at weight 0.637 Kilogram/One Running Metre. with window frame bottom track section 92 x 31.75 x 1.30 mm at weight 1.070 Kilogram/One Running Metre.. Top and side track section 92 x 31.75 x 1.30 mm at weight 0.933 Kilogram/Running metre. The shutter should be of bearing bottom 40 x 18 x 1.25 mm at weight 0.417 Kilogram/One Running Metre. Inter locking section 40 x 18 x 1.10 mm at weight 0.469 Kilogram/Running metre. and handle and top section 40 x 18 x 1.25 mm at weight 0.417 Kilogram/Running metre. As per detailed drawings and as directed by Engineerincharge with all necessary Aluminium sections fixtures and fastenings such as roller bearing in nylon casting and self locking catch fitted in vertical section of shutter including 5 mm thick plain glass and aluminium mosquito net shutter with stainless steel jail with all required screws and nuts etc, complete. With powder coating without box
Addnl. Spec.: As Directed by Engineer In Charge
SSR 2022-23 Item No. 39.44~Page No. 254

Seed Processing Machinery Unit W	13	1.50		1.20	23.40	
				Total	23.40	Sq.M

ITEM No.17: Providing and fixing rolling shutter fabricated from steel laths of minimum thickness 0.9 mm with lock plate of 3.15 mm thickness reinforced with 35 x 35 x 5 mm angle section fitted with sliding bolts and handles for both sides, deep M.S. channel section of depth and thickness not less than 65 mm and 3.15 mm respectively with hold fast arrangements, M.S. Bracket plate 300 x 300 x 3.15 mm minimum size and shape with square bar, suspension shaft of minimum 32 mm diameter, hood cover of M.S. sheet not less than 0.9 mm thickness and of any size at top and safety devices including mechanical gear operation arrangement consisting of worm gear wheels and worms of high grade cast iron or mild steel and one coat of red lead primer etc. complete. (I.S. 62481979) (With mechanical gear)
 Addnl. Spec.: BD-T-55 Page One Number 510
 SSR 2022-23 Item No. 39.25 Page No. 249

Seed Processing Machinery Unit R.S.	1	4.05		3.80	15.39	
				Total	15.39	Sq.M
Seed Processing Machinery Unit R.S.	1	4.05		4.30	17.42	
				Total	17.42	Sq.M

ITEM No.18: Providing preconstructional antitermite treatment as per I.S. 6313 (Part-II) by treating the top surface of plinth filling at the rate of 5 litres of emulsion concentrate at 1.0 percent of clorophyrifos per One Square Metre of surface area covering ten years guarantee on bond paper.
 Addnl. Spec.: As Directed by Engineer In Charge
 SSR 2022-23 Item No. 21.24 Page No. 156

Seed Processing Machinery Unit	1	13.49	17.99		242.69	
				Total	242.69	Sq.M

ITEM No.19: Providing and fabricating structural steel work in rolled sections like joists, channels, angles, tees etc. as per detailed design and drawings or as directed including cutting, fabricating, hoisting, erecting, fixing in position making riveted / bolted/welded connections without connecting plates, braces etc. and including one coat of anticorrosive paint and over it two coats of oil painting of approved quality and shade etc. complete.
 Addnl. Spec.: Bd.C.2 Page One Number 275
 SSR 2022-23 Item No. 23.01 Page No. 173

Seed Processing Machinery Unit						
Lift Upto 3.80 Mtr. From Plinth						
Steel Stanchions						
152 X 152 X 23 KG/M UNIVERSAL COLUMN (WEB: 6.1MM / FLANGE: 6.8MM)						
For Seed Processing Machinery Unit Columns C1, C2, C3, C4, C5, C6, C7, C8, C9, C10, C11, C12, C13, C14	14	3.80	x	23.00	1223.60	
Hz. Supports to profiled sheet walling at bottom, Mid & Top						
25 X 25 X 3MM (SHS) SQUARE STEEL HOLLOW SECTION (2.04 KG/M)						
For Seed Processing Machinery Unit G. L. Beams C1-C2, C2-C3, C3-C4, C11-C12, C12-C13, C13-C14	6x3	4.35	x	2.04	159.73	
For Seed Processing Machinery Unit G. L. Beams C1-C5, C5-C7, C7-C9, C9-C11 C4-C6, C6-C8, C8-C10, C10-C14	8x3	4.47	x	2.04	218.85	
				Total	1602.18	Kg.

Vertical Members	5x39	0.310	x	6.97	421.34	
Inclined Members	5x38	0.440	x	6.97	582.69	
Purlins	9	18.200	x	6.97	1141.69	
Rafters	13	13.73	x	6.97	1244.08	
Rolling Shutter Supports	2	4.35	x	6.97	60.64	
25 X 25 X 3MM (SHS) SQUARE STEEL HOLLOW SECTION (2.04 KG/M)						
Window Vertical Supports	13x2	1.20	x	2.04	63.65	
Window Horizontal Supports	5x2	4.35	x	2.04	88.74	
	8x2	4.47	x	2.04	145.90	
				Total	5418.56	Kg.
Add 5% For Base Plates, Connecting Plates, nut bolts, wastage	5%	x	5418.56	=	270.93	
				Total	5689.49	Kg.
				=	5.69	M.T.

ITEM No.20: Providing and fixing colour coated Zinalume (R) AZ150 (min 150 gms/sq.mt. total on each side) profiled sheets for roofing. The feed material is manufactured out of nominal 0.45 mm Base Metal Thickness (BMT) (0.5 mm TCT), Hi-strength steel with min.550 MPa yield strength, metallic hot dip coated with Aluminium-Zinc alloy (55% aluminium 43.4% zinc 1.6% silicon) with COLORBOND (R) steel quality super durable polyester paint coat (with inorganic pigment). The paint shall have a total coating thickness of nominal 35 um, comprising of nominal 25 um exterior coat on top surface and nominal 10 um reverse coat on back surface. Profile sheet shall have nom. 950- 1050 mm effective cover width and nominal 25-30 mm deep ribs with subtle square fluting in the five pan at nominal 180-250 mm center-to-center. The end rib shall be designed for anti-capillary groove. and return leg. The feed material should have coil manufacturers product details marked a regular interval. Including fasteners with min. fastened with min. 25 um Zinc-Tin alloy coated, Hex head, self-drilling screw etc. complete. (weight of profile 4.52 Kilogram/ One Square Metre)
Addnl. Spec.: As Directed by Engineer In Charge
SSR 2022-23 Item No. 38.34 Page No. 236

Lift Upto 3.80 Mtr. From Plinth						
Seed Processing Machinery Unit						
F/S & B/S	2	13.730		3.80	104.35	
L/S & R/S	2	18.200		3.80	138.32	
Deductions						
R.S.	1	4.05		3.80	-15.39	
W	13	1.50		1.20	-23.40	
				Total	203.88	Sq.M.
Lift Above 3.80 To 7.60 Mtr.						
Seed Processing Machinery Unit						
F/S & B/S	2	13.73		3.80	104.35	
L/S & R/S	2	18.20		3.80	138.32	
Deductions						
R.S.	1	4.05		3.80	-15.39	
				Total	227.28	Sq.M.
Lift Above 7.60 To 11.40 Mtr.						
Seed Processing Machinery Unit						
F/S & B/S	2	13.73		1.90	52.17	
L/S & R/S	2	18.20		1.90	69.16	
Deductions						
R.S.	1	4.05		0.50	-2.03	
Roofing	1	13.73	18.65		256.06	
				Total	375.36	Sq.M.

ITEM No.21: Providing and fixing plain zinc sheeting of 0.80 mm thick (22 B.W.G.) over the ridge hip or valley to galvanized iron sheet roofing including all fastening and bolt galvanised iron screws and bolts, lead and bitumen washers etc. complete.(Weight of 6.8 Kilogram/sq.m.).

Addnl. Spec.: Bd.R.5, Page One Number 453

SSR 2022-23 Item No. 38.05 Page No. 233

Lift Upto 3.80 Mtr. From Plinth					
Seed Processing Machinery Unit	1x4		0.30	3.80	4.56
				Total	4.56
					Sq.M.
Lift Above 3.80 To 7.60 Mtr.					
Seed Processing Machinery Unit	1x4		0.30	3.80	4.56
				Total	4.56
					Sq.M.
Lift Above 7.60 To 11.40 Mtr.					
Seed Processing Machinery Unit	1x4		0.30	1.90	2.28
Roof F/S	1	13.73	0.30		4.12
Roof L/S & R/S	2	18.20	0.30		10.92
				Total	17.32
					Sq.M.

ITEM No.22: Providing and fixing in position anodised extruded aluminum partitions, partly glazed and partly laminated having frame made out of extruded tubular section of size 40 mm x 60 mm with 12 mm thick three layered flat pressed teak wood particle board bonded with BWP type exterior grade phenol formaldehyde synthetic resin conforming to IS 128231990, laminated on both sides, Novateakor equivalent and 5 mm thick selected quality plain/ float glass panels fixed with aluminum glass clips 12 mm x 12 mm and rubber cushioning beading to glass partitions as per approved drawing etc. complete

Addnl. Spec.: As Directed by Engineer In Charge

SSR 2022-23 Item No. 39.72 Page No. 260

Seed Processing Machinery Unit					
	2	9.33		2.50	46.65
	4	4.83		2.50	48.30
Deductions					
D	4	0.90		2.10	-7.56
				Total	87.39
					Sq.M.

ITEM No.23: Providing and fixing in position, Single shuttered aluminium extruded powder coated openable door of overall size 0.90 m x 2.40 m with aluminium door frame of powder coated section 101.60 x 44.75mm , 3.18 mm thick and shutter comprising of powder coated section having bottom and lock rail of size 150 mm x 44.5 mm x 3.00 mm thick top rails 47.62 x 44.45 mm x 3.00 mm thick , vertical style 47.62 x 44.45 mm, 3.00 mm thick and for shutter plain glass panes 5 mm thick for top panels and 12mm thick both side laminated phenol bonded particle board panels for bottom panels etc. , I.S.I. mark , with bijagiri having heavy duty concealed lock, necessary beading, glazing clips, PVC gaskets, 250mm length tower bolts, 150mm diam. pad handle, etc. as per detailed design and drawing or as directed by engineer in charge including all materials , labours, and equipment etc. complete

Addnl. Spec.: As Directed by Engineer In Charge

SSR 2022-23 Item No. 39.65 Page No. 259

Seed Processing Machinery Unit					
D	4	0.90		2.10	7.56
				Total	7.56
					Sq.M.

ITEM No.24: Providing and fixing 1.5 mm thick polyvenyl vinyl chloride flooring including leveling the base with white cement including pasting with appropriate material cleaning the surface etc. complete
 Addnl. Spec.: Bd.M.35C' / Page One Number 393
 SSR 2022-23 Item No. 33.39 Page No. 217

Seed Processing Machinery Unit						
Office	1	4.83	4.83		23.33	
Clearical	1	4.83	4.83		23.33	
Store	1	4.83	4.50		21.74	
Labour	1	4.83	4.50		21.74	
				Total	90.14	Sq.M.

ITEM No.25: Executive's Table @ 1800Lx900Dx750HT
 Providing & Fixing of Table @ 1800Lx900Dx750HT - TOP & GABLE END to be made of Membrane finish with soft water fall edges & curved panel & Decorated Anodized section MODESTY PANEL to be made of 18 mm thick Prelaminated particle board with PVC edge band as per drawing
 Addnl. Spec.: As Directed by Engineer In Charge
 SSR 2022-23 Item No. 51.21 Page No. 355

Seed Processing Machinery Unit						
Office	1				1.00	
Clearical	1				1.00	
				Total	2.00	No.

ITEM No.26: Providing & Arrangemnt of High Back Chair - TILT MECHANISM WITH MULTILOCKING, HIGH DENSITY CUSHION ON SEAT COMPOSITE LEATHER WITH METALLIC SILVER FINISH BASE AND ARMS WITH P.U.CASTORS GASLIFT FOR HEIGHT ADJUSTMENT.
 Addnl. Spec.: As Directed by Engineer In Charge
 SSR 2022-23 Item No. 51.41 Page No. 359

Seed Processing Machinery Unit						
Office	1				1.00	
				Total	1.00	No.

ITEM No.27: Providing & Arrangemnt of Mld Back, Normal Syncro Mechanism , Fixed Armrest , Gaslift for Seat height adjustment, Standard 5-prong/Nylon Base with Leather Upholstery
 Addnl. Spec.: As Directed by Engineer In Charge
 SSR 2022-23 Item No. 51.42 Page No. 359

Seed Processing Machinery Unit						
Clearical	2				2.00	
				Total	2.00	No.

ITEM No.28: Public Seating Chair. - 3 Seater
 Providing and Fixing 3 seater Public seating chair made of complete metal with Legs in Crome finish and seates in silver powder coating finish.
 Addnl. Spec.: As Directed by Engineer In Charge
 SSR 2022-23 Item No. 51.44 Page No. 359

Seed Processing Machinery Unit						
Office	1				1.00	
Clearical	1				1.00	
				Total	2.00	No.

ITEM No.29: Full Height Steel Storage @ 750Lx450Dx2100HT
 Providing and fixing Openable Steel Storage of 750 x 450 x 2100Ht, with 4 adjustable shelves, Complete body & shutter made in 0.8 mm thick & Top in 2 mm thick CRCA, 4 Shutter to be mounted with the help of cup hinges, and 4 adjustable levelers, entire storage in powder coated finish with 60 to 80 microns as as per drawing.
 Addnl. Spec.: As Directed by Engineer In Charge
 SSR 2022-23 Item No. 51.37 Page No. 359

Seed Processing Machinery Unit					
Office		1			1.00
Clearical		1			1.00
				Total	2.00
					No.

ITEM No.30: Multiple Compartment Lockers @ 1140Lx 457D x 1830 mm. Ht.
 Providing and fixing Multiple Compartment Lockers @ 1140Lx 457D x 1830 mm. Ht. with 12 Compartments , Complete body & shutter made of CRCA Sheet with powder coated finish as per approved color.
 Addnl. Spec.: As Directed by Engineer In Charge
 SSR 2022-23 Item No. 51.38 Page No. 359

Seed Processing Machinery Unit					
Labour		1			1.00
				Total	1.00
					No.

ITEM No.31: Providing and applying two coats of water proof cement paint of approved manufacture and of approved colour to the plastered surfaces including scaffolding if necessary, cleaning and preparing the surface, watering for two days etc. complete.
 Addnl. Spec.: Bd.0.8 Page One Number 406
 SSR 2022-23 Item No. 35.13 Page No. 224

Lift Upto 3.80 Mtr. From Plinth					
Qty. As Per I. No. 13 =					88.88
				Total	88.88
					Sq.M.

ITEM No.32: Providing and applying two coats of synthetic enamel paint of approved colour to new /old structural steel work and wood work in buildings, including scaffolding if necessary, cleaning and preparing the surface (excluding primer coat) etc. complete.
 Addnl. Spec.: Bd.O.5 Page One Number 405
 SSR 2022-23 Item No. 35.07 Page No. 223

Lift Upto 3.80 Mtr. From Plinth					
Seed Processing Machinery Unit R.S.	2x2x1.50	4.05		3.80	46.17
				Total	46.17
					Sq.M.
Lift Above 3.80 To 7.60 Mtr.					
Seed Processing Machinery Unit R.S.	2x2x1.50	4.05		4.30	52.25
				Total	52.25
					Sq.M.

ITEM No.33: Royalty charges for supply of Sand, Rubble, Murum, Soil, 60mm./40mm. metal (Hand broken) as per The Government of Maharashtra, Revenue and Forest Departments Gazette No.146 Dt. 04 June 2021 States that the Royalty charges of Rs. 600/- Per Brass (i.e. Rs.211.95 /cum.) are to be considered. The surcharge levied on Royalty shall also be payable to the contractor in following manner . Royalty charges on all minor minerals do not form part of Rate Abstract and shall be reimbursed separately on production of proof to that effect. The Superintending Engineer, PWD may modify and circulate Royalty charges in case of any modifications are made by Govt. of Maharashtra. Royalty charges against estimated quantity shall be included in Recapitulation sheet.

a) For sand = Royalty + surcharge (2%) + Distt. Mineral Foundation Cess (10%)

= 211.95+4.23+21.19 = 237.37 Per Cum

b) For All Other Minerals = Royalty + surcharge (2%)

= 211.95+4.23 = 216.18 per cum

Ntrl / Screened Sand Qty. as per statement attached	=	0.00	Cu.M.
Other Material			
Stone/ H.B. Metal Qty. as per statement attached	=	73.99	
Murum Qty. as per statement attached	=	10.32	
	Total	84.31	Cu.M.

ITEM No.34: Laboratory testing charges for various materials, on the basis of testing frequency and charges fixed by Vigilance & Quality Control Circle, for the current year.

For Specific tests like span load tests, plate/ pile load test etc. which are not included in the rate analysis of item, the rates for these tests will be prepared on the basis of rates approved by M.E.R.I./ any competent Institute of Govt. of Maharashtra or Govt. of India.

CONCRETE Compressive Strength OF C.C. Cube(Set of 3 cubes).	For	54.72	Cu.M.	=	4.00	1 Test
---	------------	--------------	--------------	---	-------------	--------

Rajendra Ghodake
 Consulting Civil Engineer
 Reg.No.CBOOM/R/2021/APL/00237
 OMC, Osmanabad
 Cell 9403050003/8788717415



VASTU-SANSKRUTI

OPP. B. & C. OFFICE
SAMTA COLONY, OSMANABAD
9403050003, 8788717415

Er. Rajendra Ghodake (D.C.E)

ENGINEERS
CONTRACTORS
ESTIMATORS
DESIGNERS
SURVEYORS

Name Of Work: CONSTRUCTION OF SEED PROCESSING MACHINERY UNIT
FOR SUMBHEKAR AGRO PRODUCER COMPANY LTD. SUMBHA, IN GAT. NO. 243,
AT SUMBHA, TQ. & DIST. OSMANABAD.
UNDER STATE OF MAHARASHTRA'S AGRI - BUSINESS & RURAL TRANSFORMATION PROGRAM (SMART)
PROJECT WORLD BANK ASSISTED

RATE ANALYSIS

ITEM No.4: Filling in plinth and floors with contractors material/brought from outside and approved by Engineer incharge in layers of 15 cm to 20 cm including watering and compaction etc. complete.

Addnl. Spec.: Bd.A.11 Page One Number 263
SSR 2022-23 Item No. 21.37 Page No. 157
Rate as per SSR

	=	1.00	x	219.98	=	219.98
Add lead for murum	=	1.00	x	0.00	=	0.00
Difference cost of murum	=				=	<u>0.00</u>
				Total	=	818.98 /Cu.M.

ITEM No.5: Providing soling using 80 mm size trap metal in 15 cm. layer including filling voids with Crushed sand/grit, ramming, watering etc. complete.

Addnl. Spec.: As Directed by Engineer In Charge
SSR 2022-23 Item No. 21.40 Page No. 157

Rate as per SSR

	=	1.000	x	330.77	=	330.77
Add lead for 80 mm Metal	=	0.15	x	345.15	=	51.77
Add lead for Grit (6 mm Metal)	=	1.00	x	0.00	=	0.00
60 mm metal Difference cost of 80 mm Metal	=				=	<u>0.00</u>
Difference cost of Grit (6 mm Metal)	=	0.15	x	0.00	=	<u>0.00</u>
				Total	=	1836.54 /Cu.M.

ITEM No.6: Providing and filling in the foundation with sand of approved quality including watering, compacting etc. complete. (To be executed with prior approval of Superintending Engineer)

Addnl. Spec.: Bd.A.13 Page One Number 264
SSR 2022-23 Item No. 21.39 Page No. 157

Rate as per SSR

	=	1.00	x	345.15	=	345.15
Add lead for Cr.Sand	=	1.00	x	0.00	=	0.00
Difference cost of Cr.Sand	=				=	<u>0.00</u>
				Total	=	2505.15 /Cu.M.

ITEM No.10: Providing and laying Cast in situ/Ready Mix cement concrete M-20 of trap / granite/quartzite/ gneiss metal for R.C.C. beams and lintels as per detailed designs and drawings or as directed including steel centering, formwork, cover blocks, laying/pumping, compaction and roughening the surface if special finish is to be provided and curing etc. complete. (Excluding reinforcement and structural steel). with fully automatic micro processor based PLC with SCADA enabled reversible Drum Type mixer/ concrete Batch mix plant (Pan mixer) etc. complete. With fine aggregate (Crushed sand VSI Grade)

Addnl. Spec.: Bd.F.6 Page One Number 300 and B.7, Page One Number 38

SSR 2022-23 Item No. 25.50 Page No. 181

Rate as per SSR				=	12269.00
Deduct For SCADA	=	1.00	x	126.00	= -126.00
Add lead for Cement	=	7.00	/	20.00	x 269.45 = 94.31
Add lead for VSI Sand	=			0.425	x 391.50 = 166.39
Add lead for 20 mm Metal	=			0.60	x 345.15 = 207.09
Add lead for 10/12 mm Metal	=			0.30	x 345.15 = 103.55
Difference cost of VSI Sand	=			0.425	x 0.00 = 0.00
Difference cost of 20 mm Metal	=			0.60	x 0.00 = 0.00
Difference cost of 10/12 mm Metal	=			0.30	x 0.00 = 0.00
				Total	= <u><u>12714.34</u></u> /Cu.M.
Lift Above 3.80 To 7.60 Mtr.	=	1%	x	12269.00	= <u>122.69</u>
					<u><u>12837.03</u></u> /Cu.M.
Lift Above 7.60 To 11.40 Mtr.	=	1%	x	12269.00	= <u>122.69</u>
					<u><u>12959.72</u></u> /Cu.M.

ITEM No.11: Providing and fixing in position TMT - FE - 500 bar reinforcement of various diameters for R.C.C. pile caps, footings, foundations, slabs, beams columns, canopies, staircase, newels, chajjas, lintels, pardis, copings, fins, arches etc. as per detailed designs, drawings and schedules. including cutting, bending, hooking the bars, binding with wires or tack welding and supporting as required complete.

Addnl. Spec.: Bd.F.17, Page One Number 306

SSR 2022-23 Item No. 26.33 Page No. 188

Rate as per SSR					= 89703.00
Add lead for steel	=			1.00	x 269.45 = 269.45
				Total	= <u><u>89972.45</u></u> /M.T.
Lift Above 3.80 To 7.60 Mtr.	=	1%	x	89703.00	= <u>897.03</u>
					<u><u>90869.48</u></u> /M.T.
Lift Above 7.60 To 11.40 Mtr.	=	1%	x	89703.00	= <u>897.03</u>
					<u><u>91766.51</u></u> /M.T.

ITEM No.12: Providing second class Burnt Brick masonry with conventional/ I.S. type bricks in cement mortar 1:6 in foundations and plinth of inner walls/ in plinth external walls including bailing out water manually, striking joints on unexposed faces, raking out joints on exposed faces and watering etc. Complete.

Addnl. Spec.: Bd.G. 1 Page One Number 313

SSR 2022-23 Item No. 27.01 Page No. 197

Rate as per SSR					= 7755.00
Add lead for Cement	=	1.58	/	20.00	x 269.45 = 21.29
Add lead for Screened VSI Sand	=			0.32	x 391.50 = 125.28
Add lead for Bricks	=	475	/	1000.00	x 883.24 = 419.54
Difference cost of Screened VSI Sand	=			0.32	x 0.00 = 0.00
Difference cost of Bricks	=			475.00	x 0.00 = 0.00
				Total	= <u><u>8321.11</u></u> /Cu.M.

Name Of Work: CONSTRUCTION OF SEED PROCESSING MACHINERY UNIT
FOR SUMBHEKAR AGRO PRODUCER COMPANY LTD. SUMBHA, IN GAT. NO. 243,
AT SUMBHA, TQ. & DIST. OSMANABAD.
UNDER STATE OF MAHARASHTRA'S AGRI - BUSINESS & RURAL TRANSFORMATION PROGRAM (SMART) PROJECT WORLD BANK ASSISTED

Sr. No.	Material	Source	LEAD CHART					Pay Load Factor	Unit	Net Lead Charges	Remark
			Total Lead In Km.	Lead Charges	Initial Lead In Km.	Initial Lead Charges	Net Lead In Km.				
With Machine Loading											
1	Murum	Gairan	3.00	1319.89			3.00	1319.89	6.00	Cu.M.	219.98
2	Stone	Jaggi Quarry	10.00	1984.62			10.00	1984.62	4.70	Cu.M.	422.26
3	Cr. Sand	Jaggi Quarry	10.00	1984.62			10.00	1984.62	5.75	Cu.M.	345.15
4	VSI Sand	Murud	13.50	2251.14			13.50	2251.14	5.75	Cu.M.	391.50
5	Stone below 40 mm	Jaggi Quarry	10.00	1984.62			10.00	1984.62	5.75	Cu.M.	345.15
6	Stone aggregate 40mm Normal size and above	Jaggi Quarry	10.00	1984.62			10.00	1984.62	6.00	Cu.M.	330.77
7	Timber	Murud	13.50	2251.14			13.50	2251.14	5.75	Cu.M.	391.50
With Manual Loading											
1	Cement	Murud	13.50	2694.55			13.50	2694.55	10.00	M.T.	269.45
2	Bricks	Murud	14.00	2742.46			14.00	2742.46	3.105	1000 Nos.	883.24
3	Steel (MS, TMT, H.Y.S.D.) Structural Steel	Murud	13.50	2694.55			13.50	2694.55	10.00	M.T.	269.45
4	Flooring Tiles Ceramic/ Marbonate	Murud	13.50	2694.55			13.50	2694.55	100.00	Sq.M.	26.95



Rajendra Ghodake
Consulting Civil Engineer

Reg.No.CBOOM/R/2021/APL/00237
OMC, Osmanabad
Cell 9403050003/8788717415

Description of Item	Quantity As Per Estimate	Cement		VSI Sand		Natural Sand		Cr. Sand		Stone/H.B. Metal		Aggregates			Bricks		Steel		Murum		CERAMIC TILES / VITRIFIED TILES		Paving Blocks		Cement Mortar Cube		Cement Concrete Cube		Flooring of Natural Stone (Kota, Marble, Granite, Tandur etc.)		Asphalt		Unit
		Rate of Consumption	Cement in bags	Rate of consumption	VSI Sand in Cu.M.	Rate of consumption	Nat. Sand in Cu.M.	Rate of consumption	Cr. Sand in Cu.M.	Rate of consumption	Stone in Cu.M.	Rate of consumption	40 mm & above Aggregates in Cu.M.	Rate of consumption	Below 40 mm Aggregates in Cu.M.	Rate of consumption	Bricks in Nos.	T.M.T./H.Y.S. Steel in D.	Rate of consumption	Hard Murum in cum	Rate of consumption	Cement Mortar in cum	Rate of consumption	Cement Concrete in cum	Rate of consumption	Flooring in Sq.M	Rate of consumption	Asphalt in Tonnes					
ITEM No.31: Providing and applying two coats of water proof cement paint of approved manufacture and of approved colour to the plastered surfaces SSR 2022-23 Item No. 35.13 Page No. 224	88.88	0.00	0.00	0.00	0.00	0.00	0.00	0.00	0.00	0.00	0.00	0.00	0.00	0.00	0.00	0.00	0.00	0.00	0.00	0.00	0.00	0.00	0.00	0.00	0.00	0.00	0.00	0.00	0.00	0.00	Sq.M		
ITEM No.32: Providing and applying two coats of synthetic enamel paint of approved colour to new/old structural steel work and wood work in buildings SSR 2022-23 Item No. 35.07 Page No. 223	46.17	0.00	0.00	0.00	0.00	0.00	0.00	0.00	0.00	0.00	0.00	0.00	0.00	0.00	0.00	0.00	0.00	0.00	0.00	0.00	0.00	0.00	0.00	0.00	0.00	0.00	0.00	0.00	0.00	0.00	Sq.M		
Lift Above 3.80 To 7.60 Mtr.	52.25	0.00	0.00	0.00	0.00	0.00	0.00	0.00	0.00	0.00	0.00	0.00	0.00	0.00	0.00	0.00	0.00	0.00	0.00	0.00	0.00	0.00	0.00	0.00	0.00	0.00	0.00	0.00	0.00	0.00	Sq.M		
		539.82		47.66		9.09		73.99		16.52		63.63		9234.00		2.13		10.32		8.00		54.72											
		26.99																															

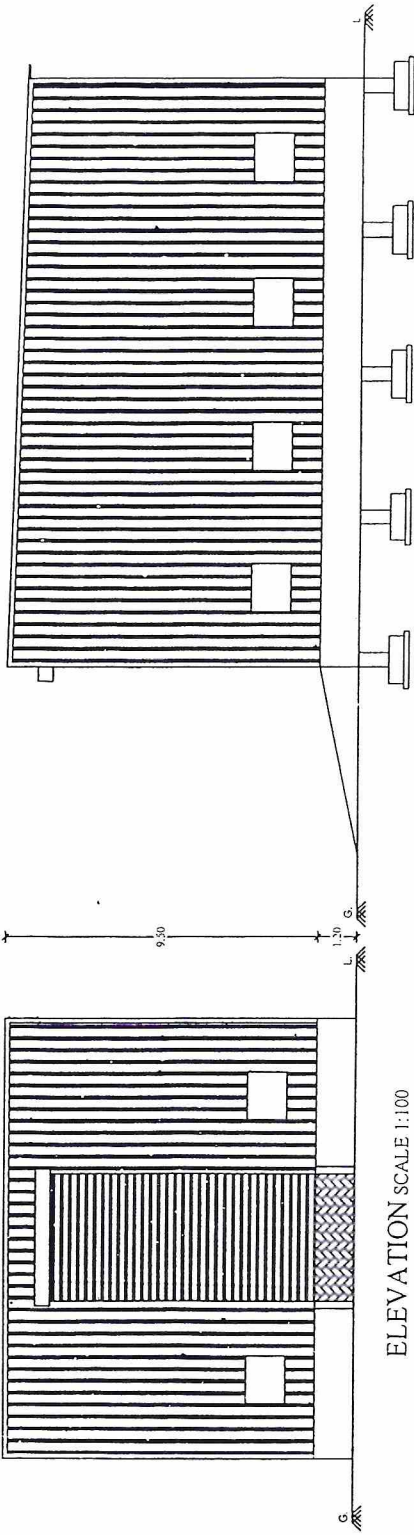

Rajendra Ghodake
 Consulting Civil Engineer
 Reg.No.CBOOM/R/2021/APL/00237
 OMC, Osmanabad
 Cell 9403050003/8788717415

SEED PROCESSING UNIT FOR SUMBHEKAR AGRO PRODUCER COMPANY LTD. SUMBHA, IN CAT. NO. 243, AT SUMBHA, TQ. & DIST. OSMANABAD

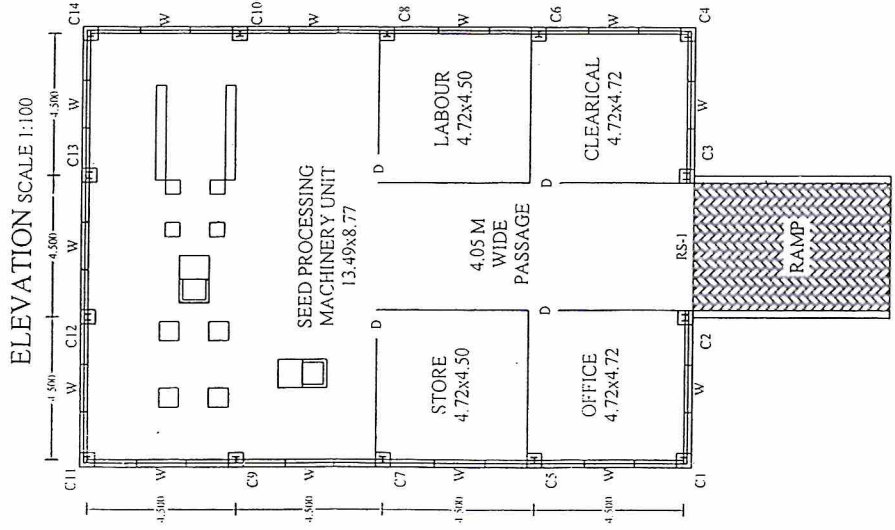

ELEVATION SCALE 1:100

SIDE ELEVATION SCALE 1:100



PLAN SCALE 1:100

AREA STATEMENT		
Sr.No.	PARTICULARS	
1.	PLOT AREA = Sq.M.	
2.	GRAIN GODOWN B/U AREA = 257.38 Sq.M.	
3.	TOTAL B/U AREA = 257.38 Sq.M.	
REFERENCES		
1)	PLOT BOUNDARY	
2)	B/U AREA	
SCHEDULE OF OPENINGS		
Sr.No	OPENING	SIZE
1.	R.S.	4.05 x 8.10
2.	D	0.90 x 2.10
3.	W	1.50 x 1.20
M.S. ROLLING SHUTTER		
ALLU. SINGLE LEAF DOOR		
ALLU. SLDG. WINDOWS OF THREE TRACKS		
NAME OF ENGINEER:		NAME & SIGN. OF OWNER:
<p>Rajendra Ghodake Consulting Civil Engineer Reg.No.CBOOM/R/2021/APL/00237 OMC, Osmanabad</p>		<p>CHAIRMAN, SUMBHEKAR AGRO PRODUCER COMPANY LTD. SUMBHA, AT SUMBHA, TQ. & DIST. OSMANABAD.</p>

Name of Work: CONSTRUCTION OF SEED PROCESSING MACHINERY UNIT FOR SUMBHEKAR AGRO PRODUCER COMPANY LTD. SUMBHA, IN CAT. NO. 243, AT SUMBHA, TQ. & DIST. OSMANABAD, UNDER STATE OF MAHARASHTRA'S AGRI BUSINESS & RURAL TRANSFORMATION PROGRAM (SMART) PROJECT WORLD BANK ASSISTED

Cell 9403050003/8788717415